

SMARTBAFFLE

BY DCI



The Bigger Better Insulation Baffle



- Strongest & Smartest Insulation Baffle
- Perfect with Spray Foam or Fiberglass
 - Ventilates Entire Rafter Bay Width
 - Installs From Rooftop or Attic Area
 - Will Not Crush, Tear or Break

1-800-622-4455
WWW.DCIPRODUCTS.COM



SmartBaffle by DCI

(Rigid Insulation Baffle)

Description: The **SmartBaffle** is designed to fit snugly between 16" & 24" on center rafters. **SmartBaffle 16** is 18.5"W x 36"L x 1/8" (thick), **SmartBaffle 24** is 26.5"W x 36"L x 1/8" (thick) corrugated plastic with double bending routes at 2" in from each long edge. Each piece can be cut in half (18") for double coverage at the eave. **SmartBaffle** is designed for use with any insulation material. **SmartBaffle** will support spray foam, loose fill, and fiberglass insulation materials.

SmartBaffle is also designed for rugged, unbreakable use and handling. **SmartBaffle** is constructed of non-collapsing material with lifetime durability. Ease of installation by the contractor is achieved by the design, engineering and technology inherent in the baffle product itself. There are many ways to secure the **SmartBaffle** but the universal method is to use an 8D nail at the center of each side when installed against the roof decking. The nails are placed tight against the **SmartBaffle**, against the lower outer surface and pressure 'tacked' in place securely, only driving the nail enough to hold the **SmartBaffle** in place. Continue until the desired amount of **SmartBaffle** is installed and then follow up installing the insulation. Insulation should fit loosely in the remaining rafter space to gain the maximum 'R' value (winter) and 'U' value (summer).

SmartBaffle is designed to allow 2" of air flow between rafters. Wider or narrower rafter spaces can be accomplished by following the directions enclosed with the product. Insulation eave protection can be achieved by cutting up from the side flange and bending the chute down at a vertical angle to fit tight against the top wall plate. Nail the side flange to hold in place.

SmartBaffle 16 & 24 Specifications:

MODEL NUMBER:	(SB16) SmartBaffle 16 used for 16" rafter spacing (SB24) SmartBaffle 24 used for 24" rafter spacing
PRODUCT DIMENSIONS:	(SB16) 18.5" Wide x 36" Long x 1/8" Thick (SB24) 26.5" Wide x 36" Long x 1/8" Thick
MINIMUM ORDER:	1 Box (SB16 - 36 Pieces, SB24 - 30 Pieces)
TERMS:	Net 30
TOTAL BOX QUANTITY:	SmartBaffle 16 - 36 Pieces, SmartBaffle 24 - 30 Pieces
TOTAL SKID QUANTITY:	SB 16 - 20 Boxes or 720 Pieces, SB24 - 24 Boxes or 720 Pieces
TOTAL BOX WEIGHT:	(SB16) - 32 lbs. per box • (SB24) - 38 lbs. per box
INDIVIDUAL BOX DIMENSIONS:	(SB16) 7" High x 19" Wide x 38" Long (SB24) 6" High x 27" Wide x 38" Long
PALLET WEIGHTS & SIZES:	SB16 - 640 lbs. (Plus Skid) 38" Long x 38" Wide x 72" High SB24 - 912 lbs. (Plus Skid) 54" Long x 38" Wide x 72" High
INCLUDED ITEMS:	Installation Instructions
RETURN POLICY:	30 DAYS UNCONDITIONAL MONEY BACK GUARANTEE. Unopened boxed products can be returned to stock within 30 days of purchase. Call first for approval. That which cannot be restocked is to be returned to DCI Products with invoice and reason for return. Upon receipt of those items DCI may replace or refund the amount of the returned merchandise after DCI approval. Only full cartons of each product may be returned in the original box tightly sealed to our location at customer's expense.
DCI Products Inc 415 S. Penn Street Clifton Heights, PA 19018 Phone: 1-800-622-4455 Fax: 1-888-356-3291 www.dciproducts.com	

SmartBaffle by DCI

Installation instructions for SmartBaffle 16 & SmartBaffle 24 (SmartBaffle is available for 16" or 24" rafter spaces, respectively)

It is important to follow each step within these instructions for proper installation of the SmartBaffle product. If you need assistance with this product installation, please call DCI Products Monday through Friday 8am- 5 pm est.
Our toll free number is 800-622-4455 or contact us via email info@dciproducts.com



Use 1/2" Staples, or 1" Screws or 1 1/4" Roofing Nails to attach baffles to side rafters.

1- To install the SmartBaffle simply bend up the 2" side flanges with the routed flange grooves facing the insulation. Insert the flanges into the rafter space ensuring that they rest against or near the underside of the roof decking. The flanges will automatically leave a 2" air space between the roof deck and the lower panel of the SmartBaffle. Slide the SmartBaffle down towards the fascia board to about 3" short of the inner side of the fascia board. This allows room for air flow from under the soffit. SmartBaffle is also designed to be used with SmartVent intake ventilation (www.dciproducts.com). Use a standard utility knife to custom cut the SmartBaffle to fit rafters, ridges and wall plates to seal for wind. The side flanges also work as nailing tabs from the rooftop or attic area. **Use a minimum of 3 fasteners per side flange to attach.**

2- The SmartBaffle (Fig. 1) installs using a small 8d nail placed proximate to the middle of the SmartBaffle on each side below the baffle, ensuring the flanges are tight to the roof deck. Install as many SmartBaffles as needed to create the rafter air chute ensuring that a clear, continuous air channel is present between the soffit intake air and the roof's exhaust air or ridge vent and the underside of the roof deck. For multiple baffle installations in one rafter bay simply abut each baffle together (recommended). Other choices include: a) overlap each baffle by 1" or b) allow 1/4" space between each baffle. NOTE: When using spray foam insulation, ALL SmartBaffles need to abut each other tightly in the same bay or overlap 1" to ensure the foam does not penetrate the air chute. **Use a minimum of 3 fasteners per side flange to attach.**

3- To create a smaller size SmartBaffle for narrow rafter spaces, simply cut the one long side, about four inches (4") wider than the width of the rafter space. Next, use a utility knife to cut "half way through" a mark made 2" in from the SmartBaffle cut off edge. This will create a flange that bends up towards the roof deck. You may practice this cut on a scrap piece of baffle material prior to working on the installed SmartBaffle to become familiar with the 1/2" cut. Another way is discussed in step #4.

4- Things to remember: ensure insulation is not inside the 2" air chute created between the roof deck and the SmartBaffle. Install SmartBaffle in all rafter spaces that have soffit intake air flow that may be blocked by insulation. Use a utility knife to make cuts. Larger size spaces can follow the next directions in step #5. Tip: To create a smaller baffle, cut the SmartBaffle long ways 1/2" less than the width of the rafter space (allowing for the flanges bending up). Once separated, overlap at the cut edges creating the size required including the flange allowances (Flange allowance is 4"). Screw the overlapped long edges together using eight 1" long screws (max.) pointed towards the roof deck for safety purposes. Using this method the space between the routes in the SmartBaffle would be the space between the narrow rafter space.

5- To create a larger SmartBaffle (Fig. 2) simply screw two flat SmartBaffles together with maximum length 1" screws (eight screws with screw points toward the roof deck when installed) ensuring the width is 4" wider than the rafter space (this allows for the 2" flanges). Then install per the above directions. Below is a sketch of the SmartBaffle installation inside a rafter space.

SmartBaffle by DCI

Installation instructions for SmartBaffle 16 & SmartBaffle 24

Use 1/2" Staples, or 1" Screws or 1 1/4" Roofing Nails to attach baffles to side rafters.

Different Installation Methods For Installing SmartBaffle

#1 Attic Side Installation Measuring Down 4" From Roof Deck to Bottom of 2" Flange

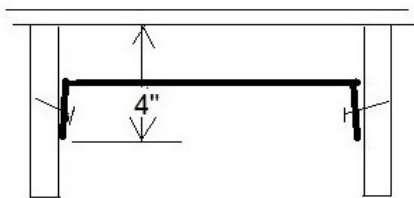

#2 Roof Top Installation with Plywood Installed After SmartBaffle.

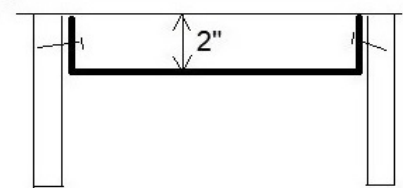

Use a minimum of 3 fasteners per side flange to attach.

#3 Attic Side Installation Cut 2" Flange 1.5" in From End of Baffle Length and Bend Down to Secure Nail. Slide Next Baffle Inside and Repeat.

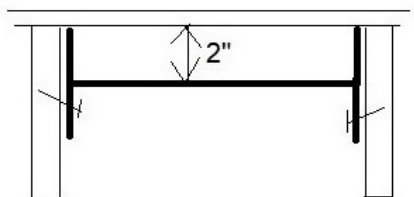

#4 Attic Side Installation Nail right Flange Against Roof Deck. Then Reverse Flange on Left Side Nailing Horizontal to Roof Deck as Shown.

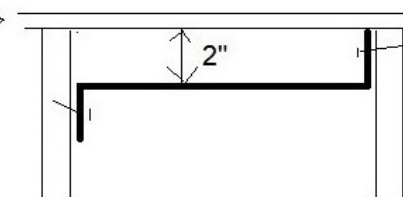

Manufactured by:
DCI Products
415 S. Penn Street
Clifton Heights, PA 19018
610-622-4455

www.DCIProducts.com

Use 1/2" staples or 1" screws or 1.25" roofing nails to attach Baffles to side wood rafters. Cuts can easily be made with a retractable type utility knife. Bends can be made by cutting halfway through plastic on the side opposite the bend direction of choice.

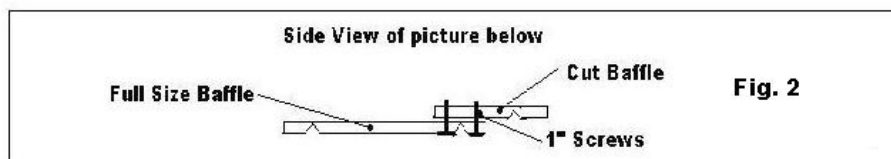
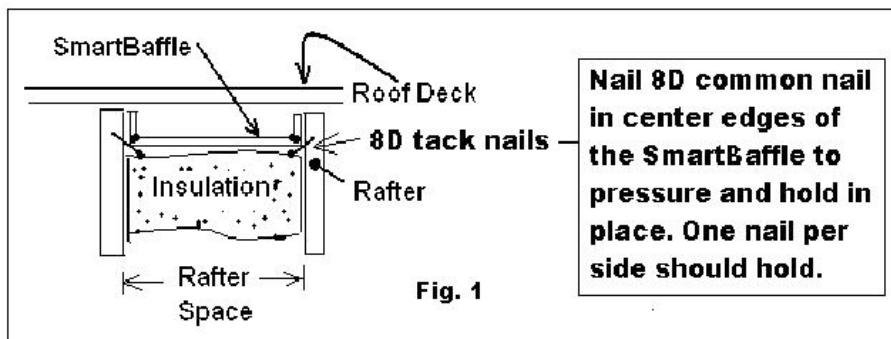

Please contact us if you would like more information regarding the various applications, usage, product safety or warranty

DCI Products 415 South Penn Street Clifton Heights PA 19018
www.dciproducts.com • 800.622.4455 • info@dciproducts.com

Rev. 202401

