



US RoofVENT by DCI

Under Shingle Roof Ventilation Instructions

Visit USROOFVENT.COM for more information



It is important to follow each step within these instructions for proper installation of the US RoofVENT product. If you need assistance with product installation, please call DCI Products Monday through Friday 8am-5pm est. Our toll free number is 800-622-4455 or contact us via email info@dciproducts.com

Attention: For installation on roof with pitch of 4/12 or greater. Do not cut rafters during installation.

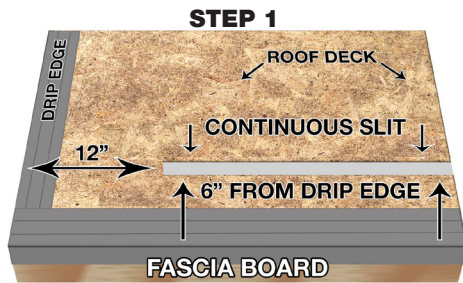

STEP 1

(Ensure metal drip edge was previously installed.)
Begin by cutting a slit 1" wide (or a series of 1 3/4" holes at 3" on center) into the roof decking 6" to 7" up from the drip edge. Do not cut slit within 12" of any gable side or valley/wall intersection

BE CAREFUL NOT TO CUT INTO THE RAFTERS!

NOTE: Ensure insulation or other obstructions are not blocking the flow of air extending from the soffit to the roof ridge. Ridge vents or other exhaust vents are required.

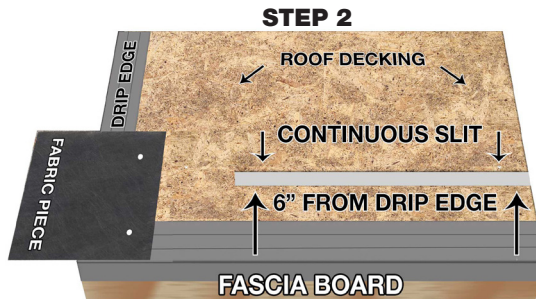

STEP 2

Place the fabric piece half way on the roof rake side edge (Gable) and even along the drip edge. Half of the fabric piece is hanging over the rake side edge of the roof.

Nail the fabric piece(s) in place with two roofing nails, one high and one low, as shown in Step 2 illustration.



STEP 3

With the smoother side of the roof vent facing up, start the installation of the US RoofVENT even at the gable edge of the roof with fabric edge (aka: lift edge) against the lower fascia drip edge. This will show the nailing line at 2.5" up from the lift edge of the US RoofVENT. Nail the US RoofVENT along the lift edge nail line every 6" - 8" while nailing the upper edge every 12". Begin and end within 1.5" of the start and end of each roll. Nails should be a minimum of 1.5" long, enough to penetrate the entire thickness of the roof deck. Wrap the remaining end fabric neatly over the US RoofVENT ensuring it is even with the drip edge. Refer to STEP 4 for wrapped fabric detail. Nail the fabric with two nails, one high and one low, as shown.



STEP 4

Continue installing the roll(s) of US RoofVENT until the opposite gable edge or to a termination point. Adjoin two rolls together by simply butting them tightly to each other. Use heavy duty household scissors to cut roll length and fabric. Repeat steps 2 & 3 to terminate the run at the opposite gable end. *Note: SmartVent Tapered End Caps are available separately to slope the vent back down to the roof. This enables the installer to make custom roof vents within the roof shingle surface and terminate the ends of the vent with ease. Use the SmartVent Tapered End Caps on the right side or left side at the roof edge, mid-roof and peak areas when needed.*

STEP 5



STEP 6



STEP 5

Install ice and water membrane on top of the US RoofVENT. Full width ice and water membrane (36") is required to be installed on top of the US RoofVENT in all environments. Ensure the upper underlayments are lapped over the lower underlayments. Please call the DCI Technical department with any questions.

STEP 6

Shingle the roof as usual. Beginning with a starter course, always overhang shingles at least by 1/2". You now have proper intake ventilation to the attic.

NOTE: Secure starter course shingles to the roof deck at the 3/4" lifted edge of the US RoofVENT with nails that penetrate through the roof sheathing. (Generally 1 1/2" roofing nails are used on new roofs.)

Shingles must overhang the US RoofVENT lifted edge 1/2" minimum to 1" maximum. Refer to shingle manufacturer application manual. Please call the DCI Technical department with any questions.

US RoofVENT can be installed under virtually any shingle course using proper installation techniques. US RoofVENT should be installed on shingled roofs with a minimum 4/12 pitch. There is no maximum slope limitation. Low sloped roofs with less than 4/12 can use FasciaVent by DCI Products to install over the US RoofVENT. This allows the ice and water membrane to be wrapped down the fascia over the vent. Call DCI Products for additional information on the FasciaVent. Use of continuous ridge vents or other exhaust vents required. No moisture discharge from household appliances, equipment, fans or fixtures can be discharged into the attic area

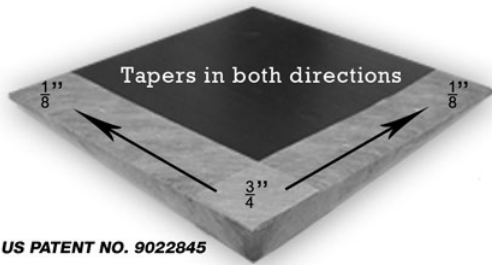

SMARTVENT END CAPS ARE AVAILABLE FOR PROVIDING SMOOTH TRANSITIONS NEAR OBSTRUCTIONS AND TERMINATIONS.

ASK YOUR DISTRIBUTOR OR CONTACT DCI PRODUCTS FOR MORE INFORMATION (SMARTVENT END CAPS ARE UNIVERSAL RIGHT & LEFT)

EASY INTAKE VENTILATION

US ROOFVENT

UNDER SHINGLE ROOF VENTILATION

CONTINUOUS ROLL - 20 FEET

9 NFA PER FOOT

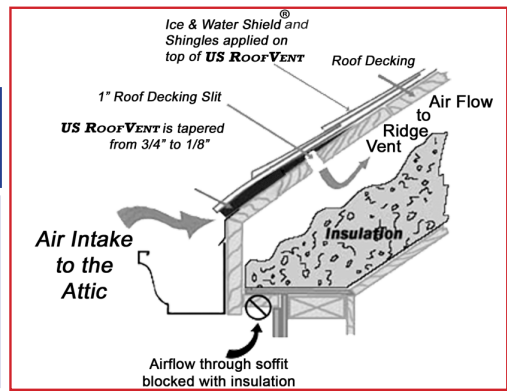
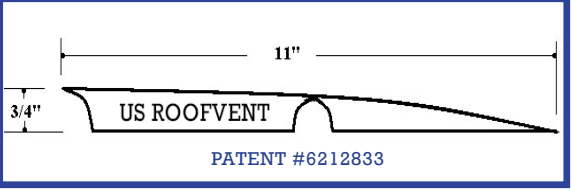

- US ROOFVENT CAN BE INSTALLED**
- ROOF EDGE
 - MID ROOF
 - ROOF TO WALL
 - OFF WALL
 - OFF PEAK
 - RIDGE & HIP

US RoofVent Mid-Roof, Off-Wall & Off-Peak Installation Instructions



Step 1

Shingle up to the area that requires the US RoofVent. (Figure 1) Do not install any underlayment or shingles above the location of the **US RoofVent** prior to the completion of the **US RoofVent** installation.



Step 2

At the location of the shingle course (where the US RoofVent is to be located) measure up from the bottom of the shingle (the weather edge) 6" to 7" before installing the actual shingle. (Figure 2)



Step 3

Make lines at the 6" and 7" marks and cut through the top of the previously installed shingle and the plywood only. Do not cut the rafters! Stay 12" in from ends of walls or obstructions. (Figure 3)

IMPORTANT NOTE:

Make sure that your blade depth is set to the thickness of the decking. Do not cut into the rafters more than 1/8".

Step 4

Remove the plywood decking after the continuous cut and ensure the air flow is open from soffit to ridge or exhaust vent



Step 5

Using the fabric at the rake edge or a US RoofVent End Cap, nail the US RoofVent similar to the eave detail CROSS SECTION but make it even with the bottom edge of the course of shingle next to be installed. Use a minimum of four nails across the lift edge starting 2" in from the edges. Use nail line in fabric. Align matching nails at the top of vent. (Figure 1)



Step 6

Apply a roll of ice shield on top of the US RoofVent even at the lower lift edge and directly to the plywood above the vent. If tarpaper was already installed, gently tuck the ice shield under the higher course of tarpaper so it laps over the ice shield by at least three inches or more. Ensure ice shield adheres to US RoofVent and wood decking, not installed over tarpaper. (Figure 4)

Step 7

Install a starter course of shingle slightly overhanging the US RoofVent bottom edge about 1/2". Align shingles per manufacturers' directions starting at 1/2" overhang. (Figure 5)



Step 8

Install the shingles over the starter course and continue shingling up the roof. The installation at the mid-roof is very similar to that of the eaves edge. If you have any questions or comments on installation please call 1-800-622-4455 and ask for a roof ventilation technician to assist you.

US RoofVent Mid-Roof, Off-Wall & Off-Peak Installation Instructions



Notes:

- Stop any roof deck 1" cuts about 12" from rake edges, dormer walls or valley areas, or at ends of the US RoofVent runs, etc.
- Use the enclosed fabric at the open ends of US RoofVent to seal for weather and insects.
- Cut US RoofVent even at the rake edges, miter US RoofVent in the valley and hip areas and return miter US RoofVent to end at locations inside the roof edging.
- The 'return miter' is available to see on our website or call to receive this installation detail. (Pre-made factory US RoofVent End Caps are available directly from our factory for ease of installation-please call 1-800-622-4455).
- Only shingle up to the area for the US RoofVent at all locations as the shingle reveal may be ½" less to compensate for the starter course overhanging the US RoofVent. This ½" overhang should match up over the entire width of the shingle course.